

# Mini Guide – Suma® Multi conc D2 conc

Available in 1.5 L Divermite



## Use for cleaning:



Floors

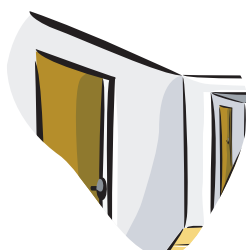

Walls



Divermite  
dispensing  
system



Spray and  
wipe



Multi-purpose  
kitchen detergent

## Using...

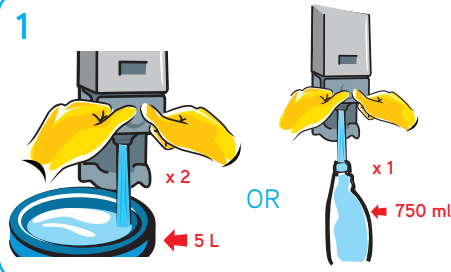

### Dilute:

2 x doses into 5 L  
of hand hot water.

OR

1 x dose into 750 ml  
spray bottle.

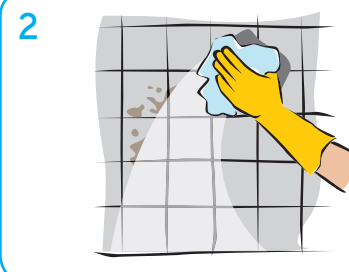

Remove debris before  
applying product.

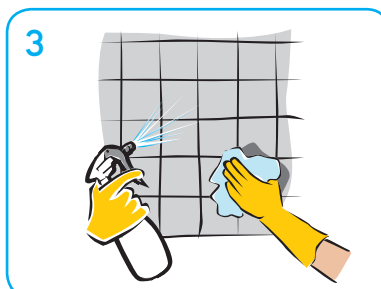

Using cloth/mop/spray,  
apply solution.

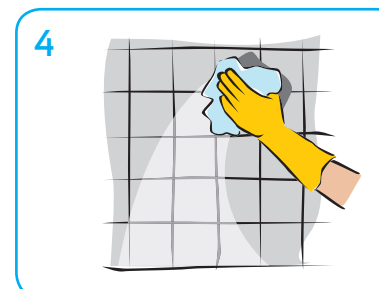

Rinse surface with  
clean water. Air dry.

